

## Table of Contents

- | [Property Details](#)
- | [Floorplan](#)
- | [Property Inclusions](#)
- | [Relevant Documents](#)
- | [Comparable Sales](#)
- | [Around Lochinvar](#)
- | [About Us](#)
- | [Disclaimer](#)

## Property Details



**22 Freeman Drive, Lochinvar**

**UNDER CONTRACT**

4  3  2 

**Under  
Contract**

1 Ensuite

Air Conditioning

Remote Garage

Floor boards

Built In Robes

Dishwasher

Welcome to an inviting family home that offers the perfect blend of space, comfort, and charm. Nestled on a generous 2777 m<sup>2</sup> block, this four bedroom, two bathroom property is ideal for families at any stage of life, whether you're starting out or looking for a place to settle down in your mature years. Located on a peaceful and quiet street, this home is a haven of tranquillity in the heart of Lochinvar, a community known for its family friendly atmosphere and picturesque surroundings. As you approach the property, you're greeted by a classic brick and tile facade, complemented by a double-width pebblecrete driveway that offers ample parking space leading up to the ornate security screen door that adds a touch of elegance and safety to the entrance.

Inside, the home is thoughtfully designed to cater to modern family living. The lounge and dining rooms feature sisal carpet, ceiling lights, and double sliding windows with heritage bars, allowing natural light to flood the space. Vertical blinds and sheer curtains provide privacy and style, while a double door linen cupboard in the hallway ensures ample storage.

The kitchen and living area boast timber laminate flooring, stone-look Laminex benches, and Laminex cabinetry. The bench mounted electric cooktop, wall-mounted electric oven, and separate grill make meal preparation a breeze. Double sliding windows, privacy roller blinds, and a sliding glass door with vertical blinds connect the indoor space to the outdoor alfresco area. Additional features include a ceiling fan, downlights, a wall-mounted Fujitsu AC, and a gas heating bayonet, ensuring year round comfort.

The master bedroom is a peaceful retreat, featuring plush carpet, a ceiling fan light, and double sliding windows with vertical blinds. The walk in robe offers plenty of storage, while the ensuite bathroom includes tile flooring, an oversized shower, a porcelain WC, a single vanity, and a wall-mounted mirror. The frosted sliding glass window and pocket cavity sliding door provide both privacy and functionality.

Bedrooms two through four are equally well appointed, with plush carpet, built in robes, vertical blinds, ceiling fan lights, and external awnings. One bedroom even includes two double door robes, offering extra storage space. The three-way main bathroom is designed with family living in mind, featuring a single vanity, a separate WC, a bath in a hob, and an oversized shower.

The outdoor alfresco area is perfect for entertaining or simply relaxing, with concrete flooring, an aluminum roof, a retractable washing line, and a porch light. The spacious garage includes two remote doors, workshop space, and internal access, making it ideal for those who need extra room for hobbies or storage.

The rear of the property is a gardener's delight, with an open lawn area, established garden beds, an original Hills Hoist washing line, and an aluminum garden shed. The property overlooks farmland, providing a serene and picturesque backdrop to your everyday life.

22 Freeman Road is more than just a house; it's a home where memories are made. Don't miss the opportunity to make it yours and experience the best of family living in Lochinvar.

This property is proudly marketed by Pat Howard, contact 0408 270 313 or Aiden Procopis 0456 664 481 for further information or to book your private inspection.

Disclaimer: All information contained herein is gathered from sources we deem to be reliable. However, we cannot guarantee its accuracy and interested persons should rely on their own enquiries.

First National Real Estate Maitland - We Put You First.



# Floorplan

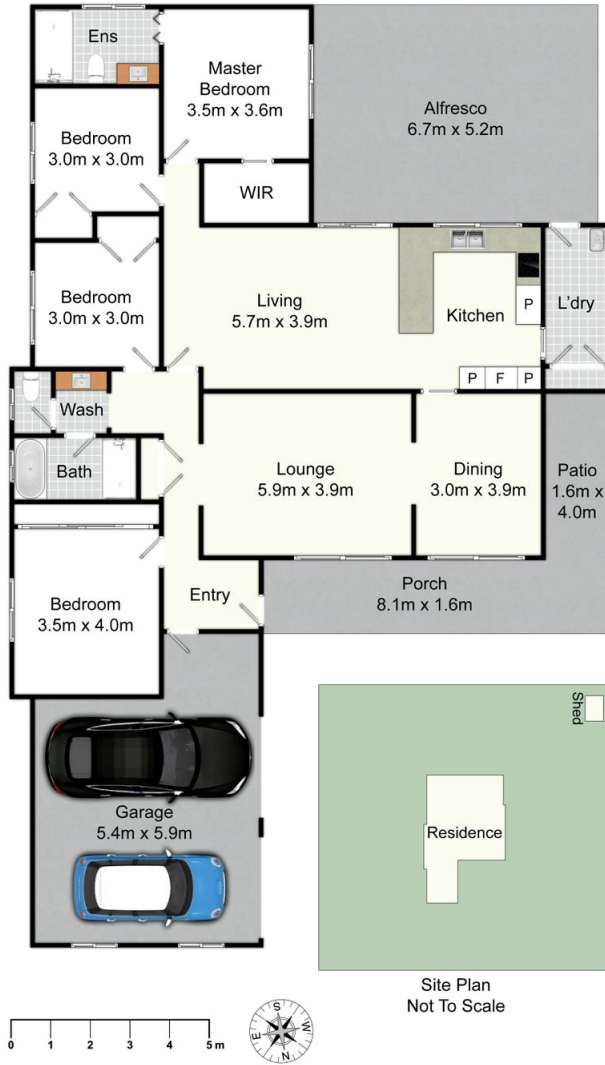

22 Freeman Dr, Lochinvar

All information contained herein is gathered from sources we deem reliable. However, we cannot guarantee its accuracy and act as a messenger only in passing on the details. Interested parties should rely on their own inquiries and the contract for sale. The floor plans are artist's impressions only. The site plan is not to scale.



## Property Inclusions

### External

#### FRONT

Brick and tile facade

Double width pebblecrete driveway

Wrap around, tiled veranda

Porch light

Two garage doors

Ornate security screen door

#### ALFRESCO

Concrete flooring

Aluminium roof

Tap

Retractable washing line

Porch light

#### GARAGE

Two remote doors

Workshop space

Two lights

Manhole

Internal access

Two windows

## REAR

Open lawn area

Aluminium garden shed

Established garden beds

Original Hills Hoist washing line

Retaining wall

Overlooking farmland

Gate to reserve at rear

## EXTRAS

NBN connected

Brand new hot water system

Connected to town water and sewer

Bottle gas

# Living Areas

## LOUNGE | DINING ROOMS

Sisal carpet

Ceiling lights

Double sliding windows with heritage bars

Vertical blinds

Sheer curtains

Double-door linen cupboard in hallway

## KITCHEN | LIVING ROOM

Timber laminate flooring

Stone look Laminex benches

Double kitchen sink

Laminex cabinetry

Bench mounted electric cooktop

Wall mounted electric oven and separate grill

Double sliding windows

Privacy roller blind

Sliding glass door

Vertical blinds

Sliding screen door

Tile splashback

Fridge neish

Microwave neish

Downlights

Ceiling fan

Wall mounted Fujitsu AC

Gas heating bayonet



# Bedrooms

## MAIN BEDROOM

Plush carpet

Ceiling fan light

Double sliding windows

Vertical blinds

Walk-in robe

## BEDROOMS TWO - FOUR

Plush carpet

Sliding window

Built in robes

Vertical blinds

Ceiling fan | light

External awnings

Two double door robes to one bedroom

# Wet Areas

## MAIN BATHROOM

Three-way design

Tile floor

Single vanity

Downlights

Separate WC

Wall mounted mirror

Separate bath and shower

Double towel rail

Sliding frosted glass windows

Exhaust fan

Oversized shower

Frosted sliding shower screen

Bath in hob

Lace privacy curtain

## ENSUITE

Tile flooring

Porcelain WC

Oversized shower

Single vanity

Wall mounted mirror

Sliding frosted glass window

Double towel rail

Pocket cavity sliding door

Ceiling exhaust and light

Frosted sliding shower screen

## LAUNDRY

Tile floor

Outdoor access

Screen door

Sliding window

Washtub

Washing machine taps

Overhead cupboards

Downlight

Roller blind

Double-door broom cupboard

## Relevant Documents

[Marketing Contract](#)

[Rental Letter](#)

[Rental CMA Pricing Report](#)

## Comparable Sales



### 58 STATION LANE, LOCHINVAR, NSW 2321, LOCHINVAR

5 Bed | 2 Bath | 5 Car  
\$998,000  
Sold on: 24/04/2024  
Days on Market: 52

Land size: 2436  
**sale - sold**



### 17 FREEMAN DRIVE, LOCHINVAR

4 Bed | 2 Bath | 2 Car  
\$1,150,000  
Days on Market: 885

Land size: 4,227sqm



### 16 FREEMAN DRIVE, LOCHINVAR

4 Bed | 3 Bath | 2 Car  
\$990,000  
Sold on: 15/07/2022

Land size: 4,153sqm

### 6 HARPERS CLOSE, LOCHINVAR

5 Bed | 2 Bath | 2 Car  
\$936,000  
Sold on: 31/05/2023

Land size: 2,993sqm

Powered by PropTrack



This information is supplied by First National Group of Independent Real Estate Agents Limited (ABN 63 005 942 192) on behalf of Proptrack Pty Ltd (ABN 43 127 386 298).

For state-specific copyright and data disclaimers, see [Copyright and Legal Disclaimers about Property Data](#).

## Around Lochinvar

LOCHINVAR - On The Edge Of The Valley

Home to both public and private school options with Lochinvar Public School, St Joseph's Catholic High School and St Patrick's Catholic Primary School, educational options are abound in this quaint historic village. Pick up your Ariats, Wranglers and Akubra hats at the famous "Airds of Lochinvar" which sits pride of place on the hill as you enter the village and which is also home to a take away food store and great country style pub. The Lochinvar Sports Complex is the home of Lochinvar Rovers Football club offering soccer to both juniors and seniors.

We acknowledge the Traditional Custodians of Country throughout Australia and pay respects to their elders past, present and emerging. The suburb of Lochinvar falls on the traditional lands of the Mindaribba people.

### AROUND LOCHINVAR

#### SCHOOLS:

- Lochinvar Primary School
- St Josephs College
- St Patrick's Primary School

#### CAFES AND RESTAURANTS:

- Lochinvar Hotel Motel
- The Royal Federal Hotel
- The Bradford Hotel
- Various world renowned restaurants right next door in Lovedale and Pokolbin and the Hunter Valley Vineyards

#### SHOPPING:

- Rutherford Shopping villiage
- IGA Branxton

\* Airds of Lochinvar

## About Us

---

---

## Disclaimer

First National David Haggarty a declare that all information contained herein is gathered from sources we deem to be reliable. However, we cannot guarantee its accuracy and interested persons should rely on their own inquiries.

All images in this e-book are the property of First National David Haggarty. Photographs of the home are taken at the specified sales address and are presented with minimal retouching. No elements within the images have been added or removed.

Plans provided are a guide only and those interested should undertake their own inquiry.